

901

McClintock

901 McClintock Dr.  
Burr Ridge, IL 60527  
Lot 2

JIM HIGDON  
jhigdon@bradfordallen.com  
630 869 5227

**BA** BRADFORD  
ALLEN

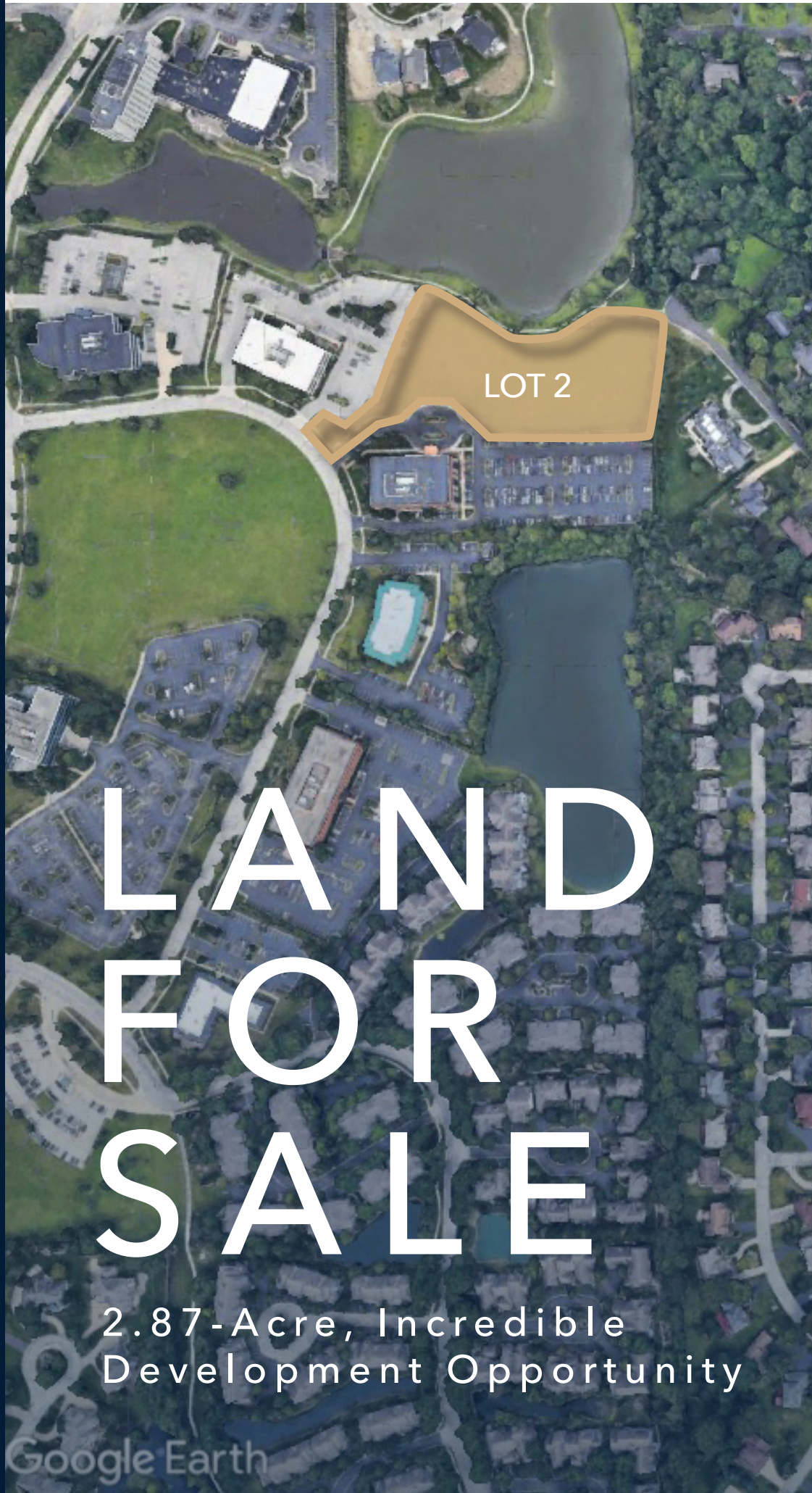

# LAND FOR SALE

2.87-Acre, Incredible  
Development Opportunity

Google Earth

# Sale Information

ADDRESS	901 McClintock Drive, Burr Ridge, IL 60527   Lot 2 (2.87 Acres)
ASKING	\$1,750,000
ZONING	O2 PUD
FAR	48,000 SF (38.3%)
LOCATION	Less than a 1/2 mile from I-55, Countyline Road, and I-294
UTILITIES	Cable, water, gas, electric, sewer, streets, irrigation, curb, gutter and sidewalk, and telephone
VISIBILITY	Approximately 460 SF of frontage on McClintock

# Demographics

	2 MILE RADIUS	5 MILE RADIUS
TOTAL POPULATION	20,680	194,801
DAYTIME EMPLOYMENT	13,229	72,999
CONSUMER SPENDING	\$354,505,952	\$2,883,463,250

# Proposed Site Plan

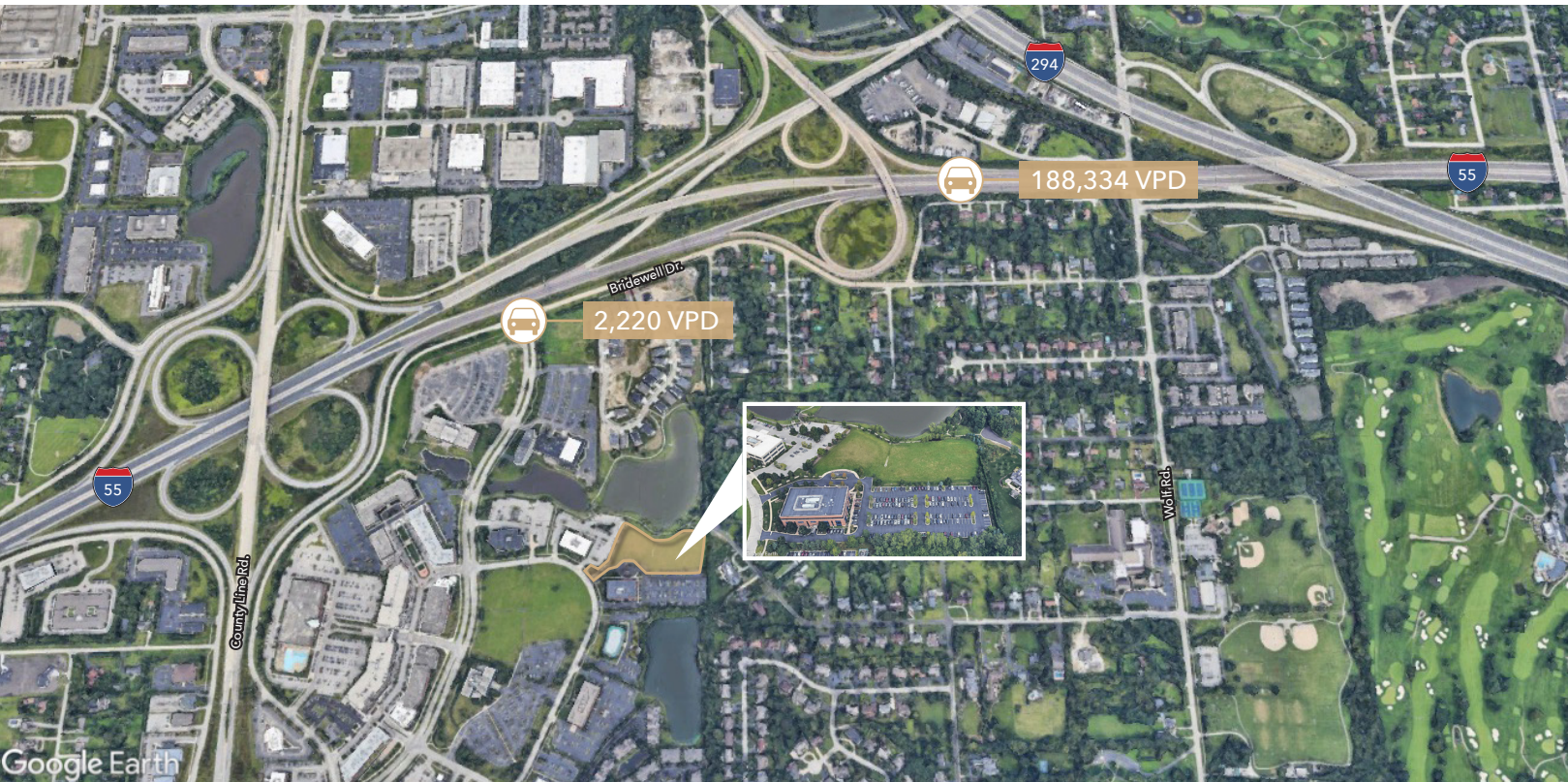
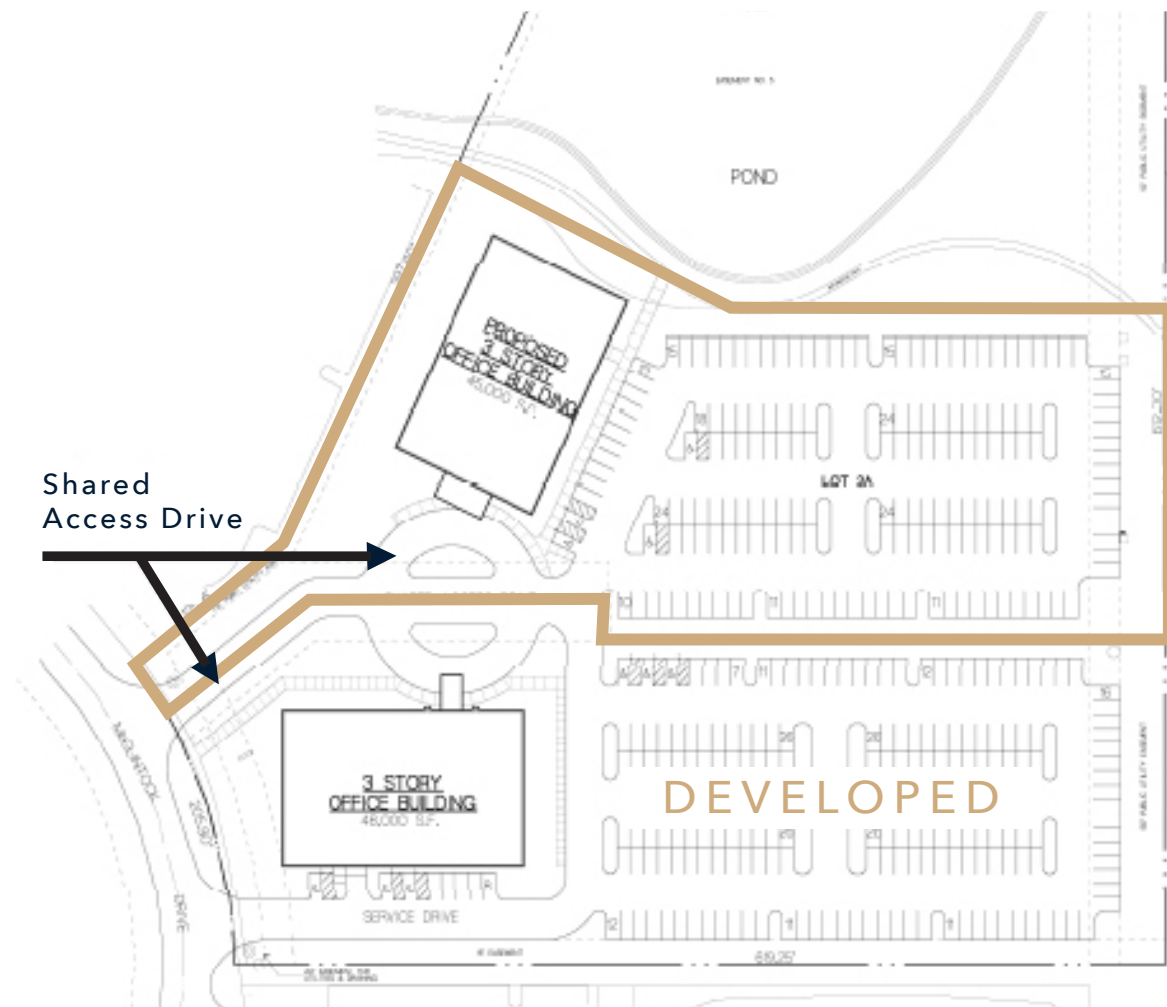

McClintock  
901

**BA** BRADFORD  
ALLEN

**JIM HIGDON**

jhigdon@bradfordallen.com  
630 869 5227

McClintock  
**901**

901 McClintock Dr.  
Burr Ridge, IL 60527  
Lot 2

© 2023 Bradford Allen.

The information contained herein has been obtained from sources deemed to be reliable; however, it has not been independently verified, and no warranties, express or implied, are made as to the accuracy thereof. Any projections, opinions, assumptions, or estimates used are for example only and do not represent the current or future performance of the property. You and your advisors should conduct a thorough, independent investigation of the property to determine to your satisfaction the suitability of the property for your needs.

[Bradfordallen.com](http://Bradfordallen.com)