



HIGHLAND PLAZA  
SOUTH HIGHLAND AVENUE  
LOMBARD

# MODERN & CLEAN

With Updated Lobby and Conference Center

529 SF - 5,890 SF AVAILABLE

## HIGHLIGHTS

- 5 / 1,000 parking ratio
- Operable windows in all suites
- Easy walk-up access to 2nd and 3rd floors
- Dedicated rooftop HVAC units to tenants' spaces
- Large building conference room for social distancing
- Refreshed lobbies with modern fixtures in common areas
- High-speed fiber optic cable
- Resurfaced parking lot
- Easy access to I-88 and I-355
- Multiple dining and shopping options nearby

For more information or to arrange a tour, please contact:

JOEL BERGER  
+1 630 225 2600 jberger@bradfordallen.com

leased exclusively by  
**BA** BRADFORD  
ALLEN



HIGHLAND PLAZA  
SOUTH HIGHLAND AVENUE  
LOMBARD

# CONTIGUOUS SPACE AVAILABLE

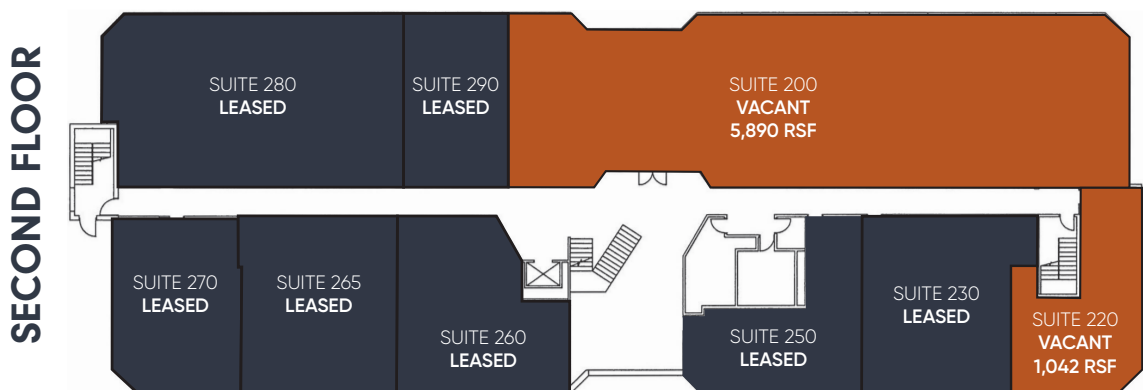
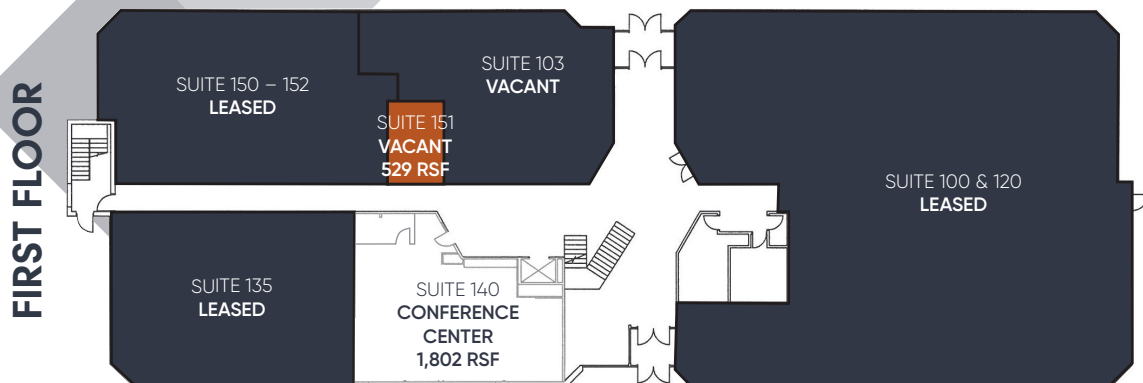

529 SF - 5,890 SF AVAILABLE

For more information or to arrange a tour, please contact:

JOEL BERGER  
+1 630 225 2600 jberger@bradfordallen.com

leased exclusively by  
**BA** BRADFORD ALLEN



For more information or to arrange a tour, please contact:

JOEL BERGER  
+1 630 225 2600 jberger@bradfordallen.com

leased exclusively by  
**BA** BRADFORD  
ALLEN